

mcfaze.

PROJECT MANAGEMENT | QUANTITY SURVEYING | DESIGN & VISUALISATION

DESIGN &  
VISUALISATION  
PACK 2021

# I N T R O D U C T I O N

McFeaze is a professional firm of Quantity Surveyors, Project Managers & Designers offering exceptional personal service to private and commercial clients alike. We have over 25 years of experience in both building and civils in a wealth of projects ranging from small house extensions, commercial fit outs through to full turnkey construction projects in various sectors, with clients ranging from the NHS to Network Rail.

We pride ourselves in being both professional and personable in our work and our aim is to provide all clients with professional and practical advice best suited to their individual needs.



# DESIGN & VISUALISATION

Our in-house Design Studio, consisting of Architect's & Creative Designers cover the creative process from start to finish, offering initial concepts, detailed technical drawings through to visualisation and final renders:

Single point of contact for all design related projects.

Liasing with all relevant parties in the construction process for design briefings.

Developing architectural visuals for marketing & PR purposes.

Design services available relative to projects, such as branding, marketing, publications & media.

Site visits ensuring clients design briefs and designs are adhered to.

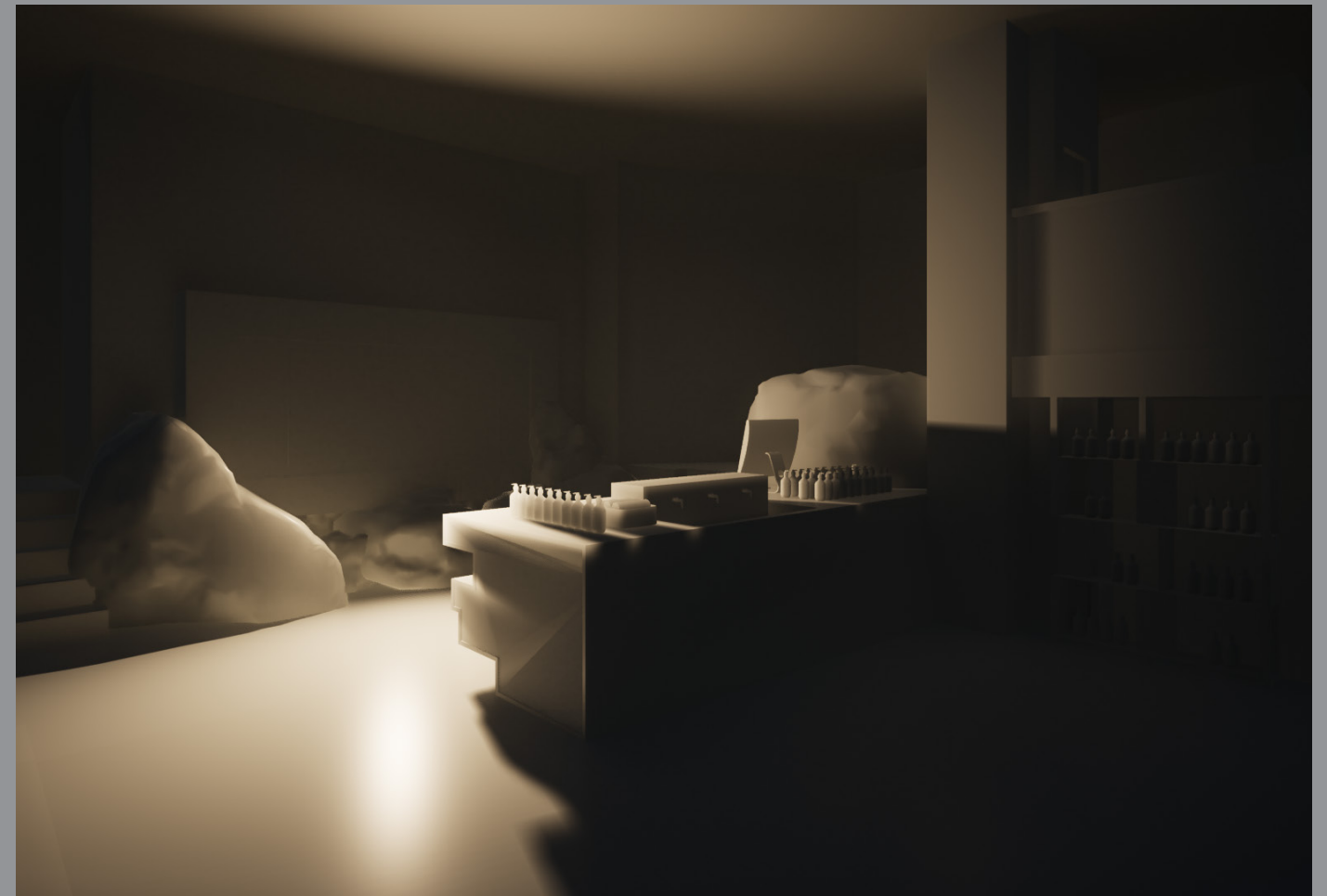



STAGE 3 VISUALISATION

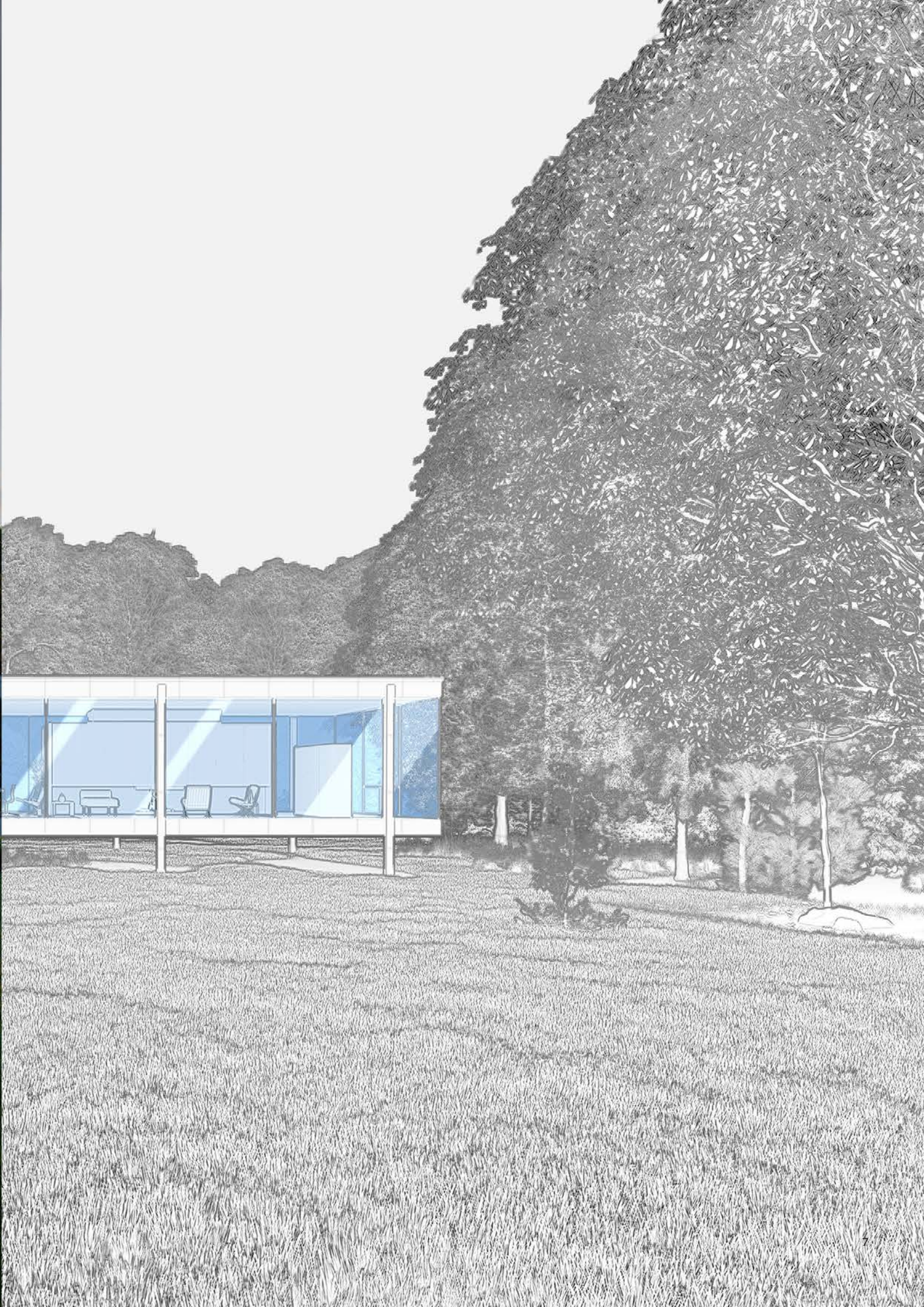







WE MODEL, WE TEXTURE & WE LIGHT JUST LIKE OTHER TOP CGI AGENCIES AND THE PROCESS OF BUILDING A 3D SCENE IS PRETTY UNIVERSAL, SO WHAT MAKES US DIFFERENT?

STAGE 3 VISUALISATION



# OUR UNDERSTANDING

We know that not every client has the same needs and with that, not every project requires the same detail or handwriting.

That's why we offer a range of stages to suit each project:

Stage 1 - sketch

Stage 2 - illustrate

Stage 3 - render

Stage 4 - complete package

## STAGE 2 VISUALISATION





# OUR PARTNERS

We believe that when we enter into a project with a client, it means more than just creating some visuals and moving on. We stick with you through the whole process offering our support throughout the entirety of the project.





# OUR CONCEPT

From an early stage, we've worked with clients to develop projects from residential to commercial properties. Unlike most agencies, we pride ourselves on taking your visuals to the next level and not just creating a 3D image that 'does the job'.

We ensure that we get the most out of every project and model we work on, whether it's being displayed to individual clients or on billboards to the general public, our aim is to stop people in their tracks and create that 'wow' factor.

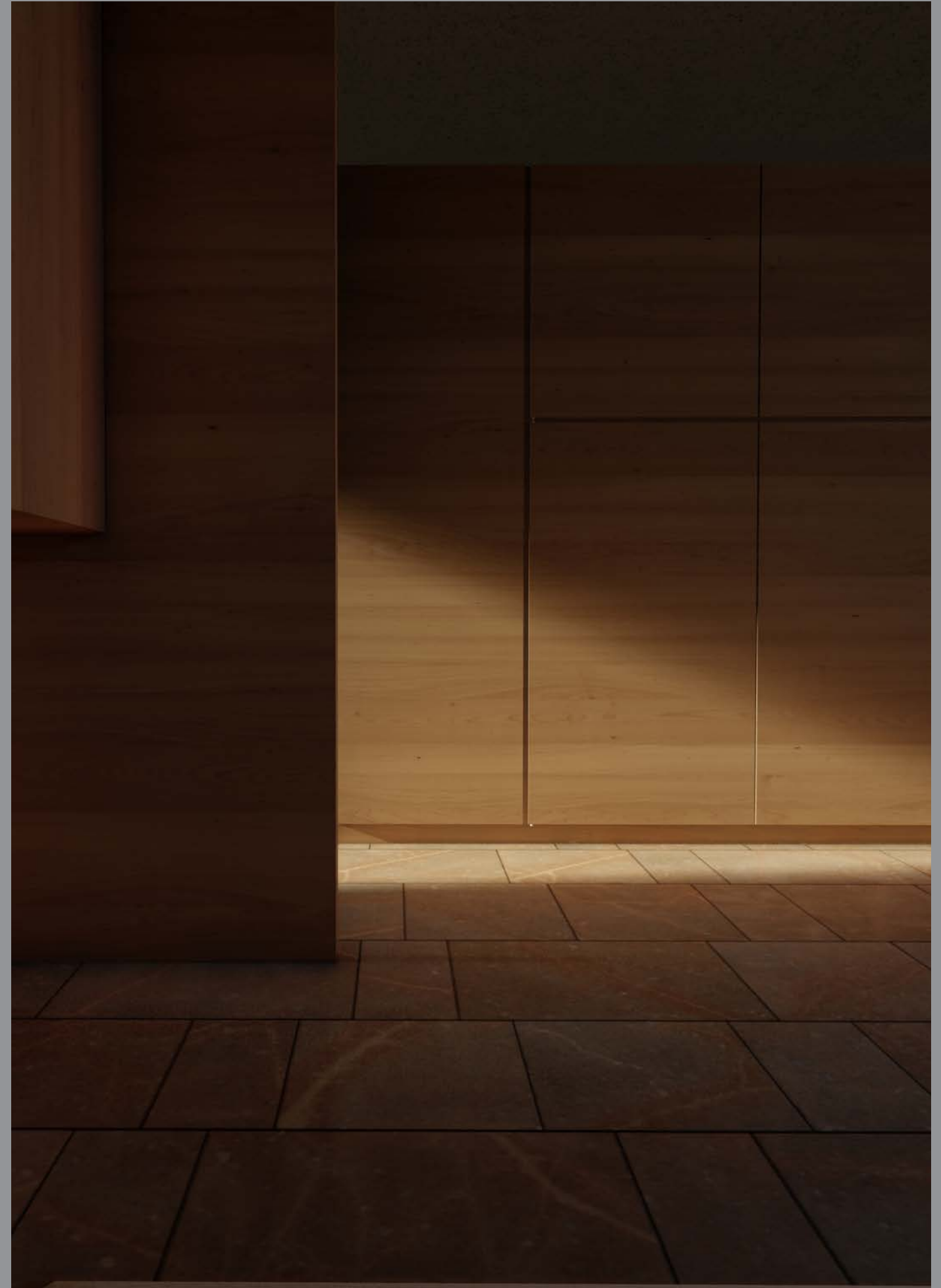



# OUR COMMITMENT

Being a small team is what makes us stronger. Less meetings, less rules, less regulations and less outdated business models. We believe in a modern working environment which means, we work around a project, not a 9-5.

So when we work with you, we really work with you. Our team are fully flexible, working to tight deadlines and with our own in-house rendering facilities it means we have the ability to turnaround projects quickly.





OUR

SERVICES



# STAGE

1

BECAUSE SOMETIMES LESS IS MORE AND NOT EVERY PROJECT REQUIRES THE SAME LEVEL OF DETAIL OR AN EQUAL LEVEL OF SPEND







Stage 1 is designed to be a quick, simple and affordable option suited to any project. We develop drawings that suit the early stages of a project to allow you, the client to visualise the possibilities of a build.

We often explore a few different options and with a site visit and consultation, we really gain an understanding of what is required of a space and open up a few avenues and possibilities that often lead into stages 2 and 3, all the while finalising the concept as we go.



STAGE

2

OUR 2D APPROACH TAKES YOUR PROJECT FROM JUST AN IDEA TO SEEING THE FIRST STAGE GETTING UNDER WAY, ADDING CREATIVITY TO YOUR ELEVATIONS AND FLOORPLANS

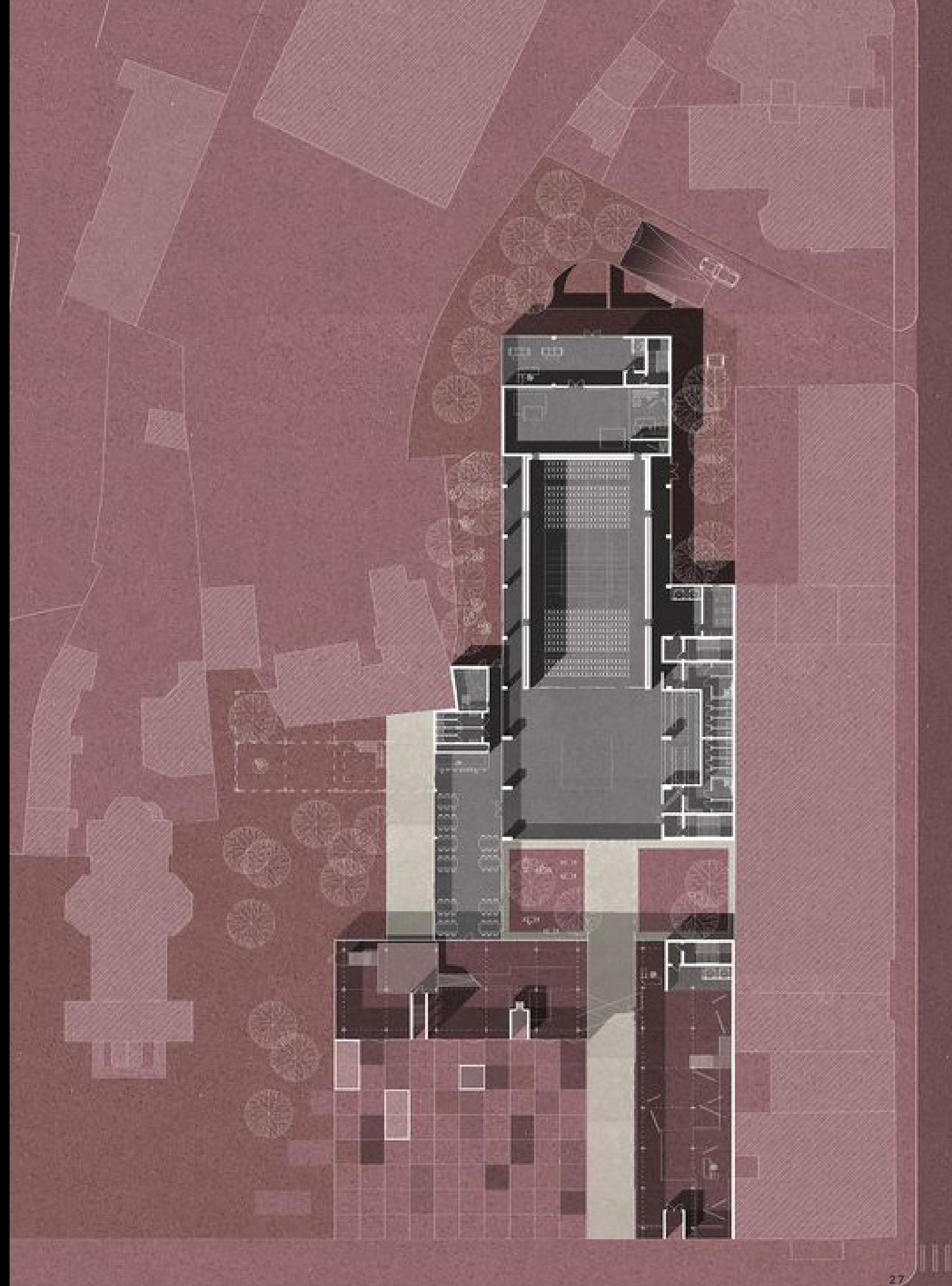



## STAGE 2

Much like Stage 1, our second stage gives you the same service albeit more refined. Sometimes a client needs to see elevations & drawings or perhaps drawings are already available and they just need a little creativity in order to get them over the line.



STAGE

3

OUR RENDERING SERVICE IS AVAILABLE FOR DESIGN, SIGN-OFF AND MARKETING PURPOSES TOO, OFFERING VISUALS FOR BOTH INTERNAL AND EXTERNAL USE





STAGE 3





STAGE 3





STAGE

4

WE CAN ALSO TAILOR A  
COMPLETE, BESPOKE PACKAGE  
THAT ENCOMPASSES ALL OUR  
SERVICES FROM CONCEPTION  
THROUGH TO COMPLETION.

PRICE ON APPLICATION

# P R I C I N G

## IMAGERY

We are a transparent partner and we like our prices to be equally as transparent where possible. Unfortunately, each project varies depending on the volume and complexity of each brief - not to mention the quality of the raw assets or technical specifications you're able to provide us with.

To give you some guidance, we have however put together the following indicative costs for your reference.

## STAGE

# 1

STARTING FROM £450 +VAT

PRODUCTION TIME 1-2 DAYS

## STAGE

# 2

STARTING FROM £650 +VAT

PRODUCTION TIME 2-3 DAYS

## STAGE

# 3

STARTING FROM £1100 +VAT

£175 +VAT FOR ADDITIONAL RENDERED IMAGE

PRODUCTION TIME 5-7 DAYS

## STAGE

# 4

PRICE ON APPLICATION



# P R I C I N G

## VIDEO

Our video services are available on our Stage 3 package. This is perfect for whether you're working on a multiple site development or if still images just isn't enough for your project and you need that extra 'wow' factor.

These prices are for guidance only and you should always get in contact to discuss your project requirements and to receive a bespoke quotation.

## STAGE

1

NOT APPLICABLE

## STAGE

2

NOT APPLICABLE

## STAGE

3

STARTING FROM £5000 +VAT PER MINUTE

PRODUCTION TIME 7-14 DAYS

## STAGE

4

PRICE ON APPLICATION

# C O N T A C T S

## DESIGN & VISUALISATION

ANDY FOX  
andy@mcfaze.co.uk

HEAD OF DESIGN

mcfaze.

PROJECT MANAGEMENT | QUANTITY SURVEYING | DESIGN & VISUALISATION

ANDREW FEAZEY  
andrew@mcfaze.co.uk

DIRECTOR

ALEX MCALL  
alex@mcfaze.co.uk

DIRECTOR